

TriPatch



REPAIR & MAINTENANCE PRODUCT

Description

TriPatch is primarily a wraparound adhesive patching system for emergency or permanent waterproof repairs to piping or flat surfaces.

Based on a fast room temperature setting epoxy resin system, the glass matting provides reinforcement preventing further environmental or mechanical damage.

Supplied in the unique TriPatch sachet, it offers excellent adhesion and sealing to most metals, plastics and rubbers.

Features & Benefits

- ◆ Installs in minutes under adverse conditions. Total down time typically 30 minutes
- ◆ No special tools or heating required
- ◆ Ideal for emergency repairs to damaged hose, pipe, cable jackets or flat surfaces
- ◆ Fully waterproof to IP68
- ◆ Operates to 90°C
- ◆ No packaging disposal problems
- ◆ Wide range of sizes to cover large and small diameter pipe work or surfaces
- ◆ Excellent adhesion and sealing to most metals, plastics and rubbers

Typical Applications



Pipe work



Hose



Flat Surface



Cable



KIT CONTENTS

The TriPatch Repair & Maintenance Product includes all the tools and accessories you'll need to carry out your repair.

The kit includes:

- ◆ TriPatch sachet
- ◆ Protective gloves
- ◆ Abrasive strip
- ◆ Solvent based wipe
- ◆ Instructions
- ◆ Safety cutter
- ◆ Over-wrapped in an aluminium foil pouch

The kit can be customised to accommodate your application or preference. In some cases, not all of the accessories are required.

Please contact:

ResinTech

Resintech Limited, Horcott, Fairford,
Gloucestershire GL7 4BX
Tel: +44 (0)1285 712755
Fax: +44 (0)1285 712999
Email: sales@resintech.co.uk
Web: www.resintech.co.uk

TriPatch

Repair & Maintenance Product

Product Design

The TriPatch system consists of a two component fast curing epoxy resin with a high strength woven glass mat reinforcement, supplied in a sachet separated by two clips. The clips are removed in sequence to first allow resin and hardener to be mixed and then glass mat to be impregnated. The saturated mat is then easily wrapped around or applied to a substrate.

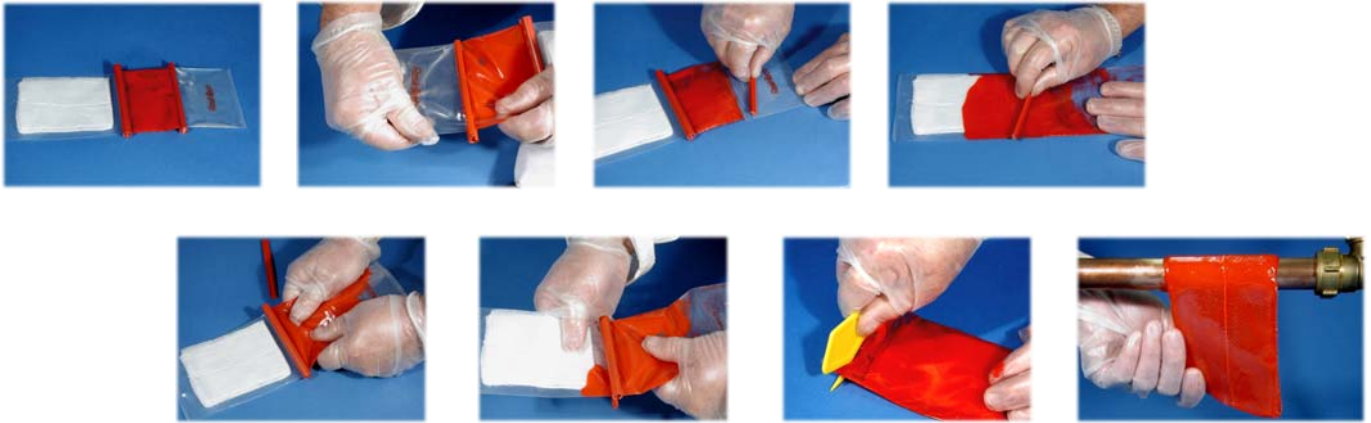

Size & Colour Options

Eight standard sizes are available in 2 main colours. Base your size selection on the outer diameter of your pipe work, cable etc. or surface to be repaired and order the appropriate kit from the table below. Special sizes are available on request.

Kit Reference	Effective Flat Coverage (mm)	Diameter Range For Effective Coverage (mm)
10 - Small	90 x 65	12 - 28
20 - Medium	180 x 65	30 - 60
30 - Large	270 x 65	45 - 90

All dimensions are nominal

Colours Available:

Main Colours



Colours "Made-to-Order"



Specification

A full technical specification is available on request. Customers are encouraged to make their own evaluations on the suitability and validity of the product for their specific application.

Safety Considerations

Epoxyes are, by their nature, irritant substances. Care should be taken when handling. Material Safety Data Sheets are freely available from Resintech or your supplier.